

Lewis
King



64 Aston Avenue, Winsford, CW7 2HS

£170,000





64 Aston Avenue

Winsford, CW7 2HS

- Beautifully Presented Throughout
- Open-Plan Living Space
- Parking Area at Rear
- Freehold Home
- Three Large Bedrooms
- Gardens to Front and Rear
- Council Tax Band A
- Close to Town Centre

Having undergone a program of renovation in recent years, this well-presented family home is a great find for anyone looking to take advantage of the size of the accommodation on offer plus the great location only a few minutes from Winsford town centre.

Boasting a large open-plan living space, followed by a modern kitchen and separate dining room, there is enough space on the ground floor for all the family and then some! On the first floor there are three sizeable bedrooms plus a three piece-suite family bathroom. Perfect for a couple of growing family!

Externally there are private gardens to both the front and rear of the property, with gated access to rear of the property allowing access to a parking area for two vehicles.

To arrange a viewing or for more information then please call Lewis King Estate Agents at your earliest convenience.

£170,000



Ground Floor

Lounge 12'1" x 21'7" (3.7 x 6.6)

Kitchen 10'2" x 8'10" (3.1 x 2.7)

Dining Area 6'6" x 12'1" (2 x 3.7)

First Floor

Bedroom One 12'5" x 12'5" (3.8 x 3.8)

Bedroom Two 13'1" x 8'10" (4 x 2.7)

Bedroom Three 11'9" x 8'10" (3.6 x 2.7)

Bathroom 9'6" x 5'6" (2.9 x 1.7)





Directions





Floor Plans

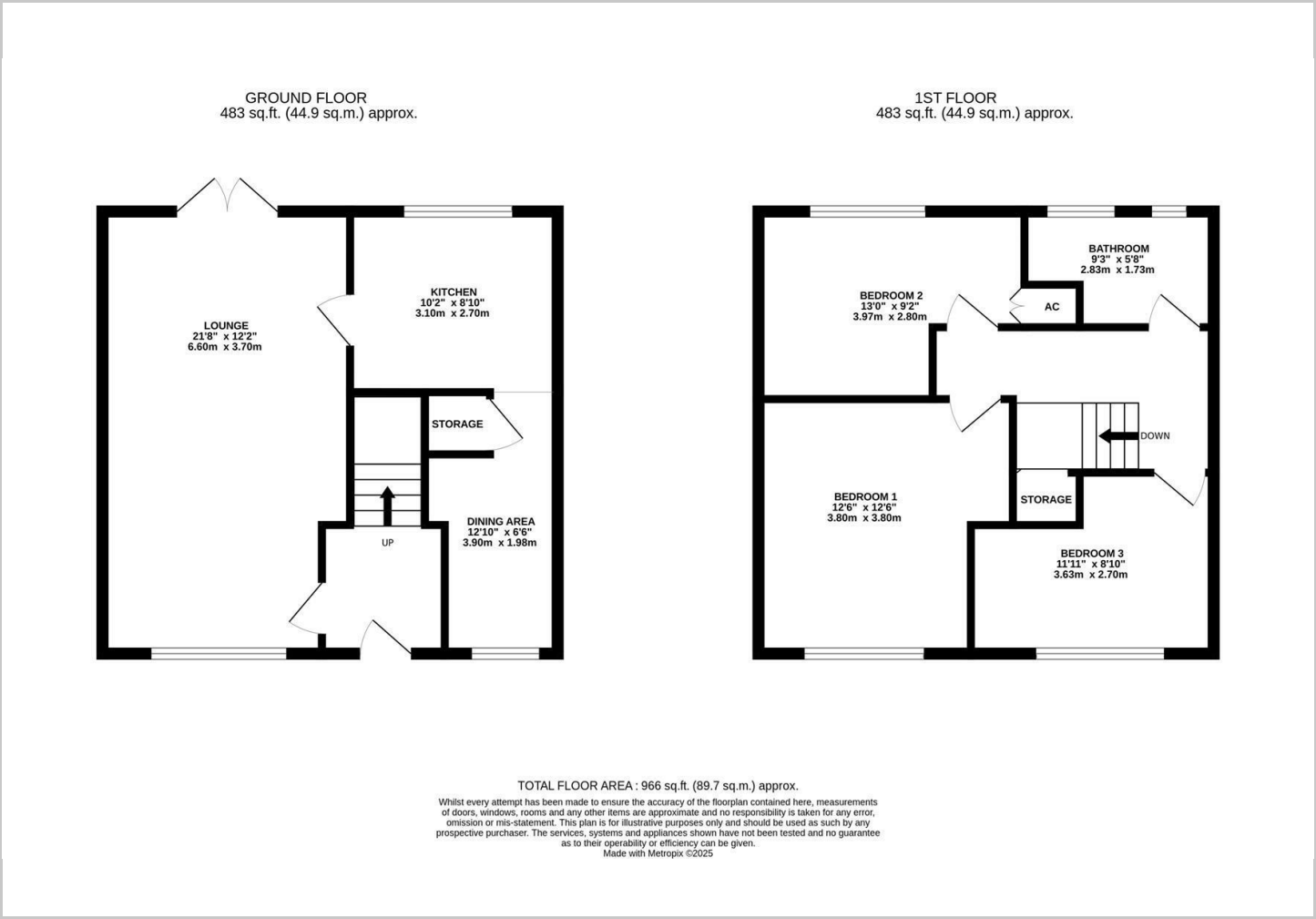

Viewing

Please contact our Sandbach Office on 01270 353753 if you wish to arrange a viewing appointment for this property or require further information.

The particulars are set out as a general outline only for the guidance of intended purchasers or lessees, and do not constitute, any part of a contract. Nothing in these particulars shall be deemed to be a statement that the property is in good structural condition or otherwise nor that any of the services, appliances, equipment or facilities are in good working order. Purchasers should satisfy themselves of this prior to purchasing.

Location Map



Energy Performance Graph

